

/ Function

Angle ball valve, full bore, with anti-leakage pipe junction, red coated alloy handle, male/female threads, double o-ring and anti-explosion command rod. Suitable for water in heating/cooling systems.

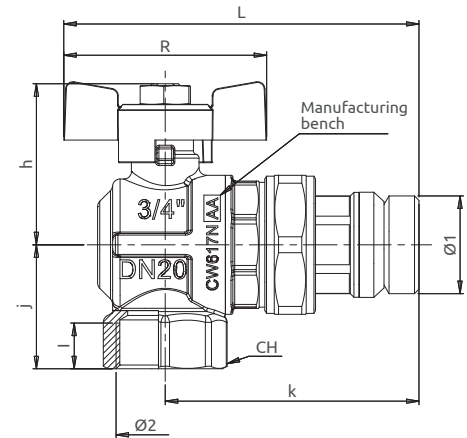
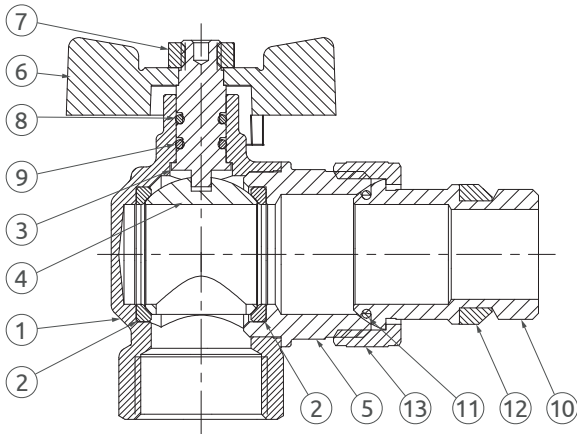
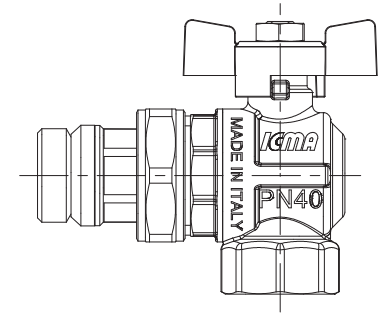

P.N.	DESCRIPTION	MATERIAL
1	SPHERE	CW617N - UNI EN 12165 - CHROME PLATED
2	SEAT GASKET	PTFE
3	BODY	CW617N - UNI EN 12165
4	SLEEVE	CW617N - UNI EN 12165
5	COMMAND ROD	CW617N - UNI EN 12165
6	HANDLE	RED COATED ALLOY
7	NUT	ZINC PLATED STEEL
8	O-RING	NBR
8b	O-RING	VITON
9	PIPE JUNCTION	CW617N - UNI EN 12165
10	CAP	CW617N - UNI EN 12165
11	O-RING	EPDM PEROX
12	GASKET	EPDM PEROX

/ Dimensions

CODE	SIZE	PN (bar)	DN	ISO 228/1		h	j	k	CH	Ø1	Ø2	ØY	I
				L	R								
87362AD11	1/2"	50	15	86	54	38	27	59	25	1/2"	1/2"	15	11
87362AE11	3/4"	40	20	95	54	43	33	68	31	3/4"	3/4"	20	12

Blue coated ally handle option available for every size (sold separately):

Handle code:
01347AD12 - 1/2" e 3/4"

Field of use

Min. operating temperature: -20°C with 50% glycol solutions
 Max operating temperature: 150°C
 Max operating pressure at 20°C

	1/2"	3/4"
bar	50	40
psi	725	580

Pressure loss at 20°C

Ball Valve - Art. 362
PRESSURE DROP DIAGRAM

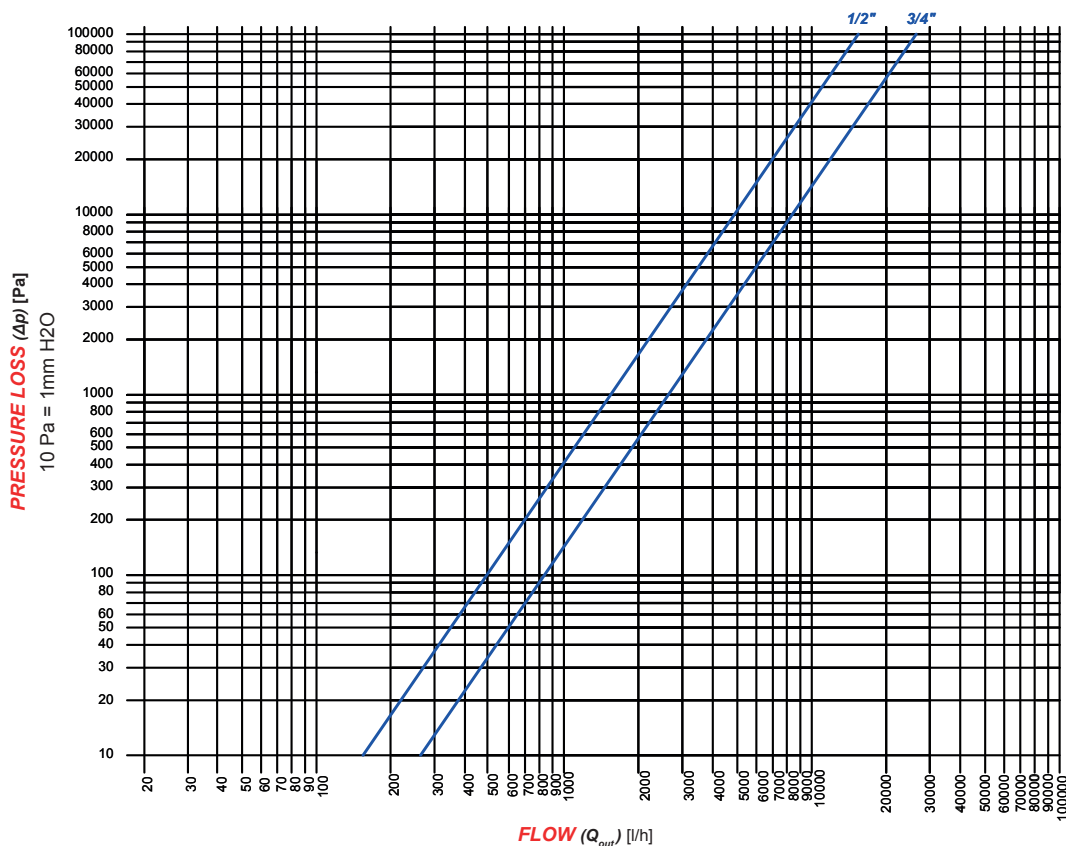

Size	Kv m ³ /h
1/2"	15,6
3/4"	26,2