

Function

Ball valve full bore, red coated alloy handle, M/F thread, double o-ring anti-explosion command rod.

Suitable for water in heating/cooling systems.

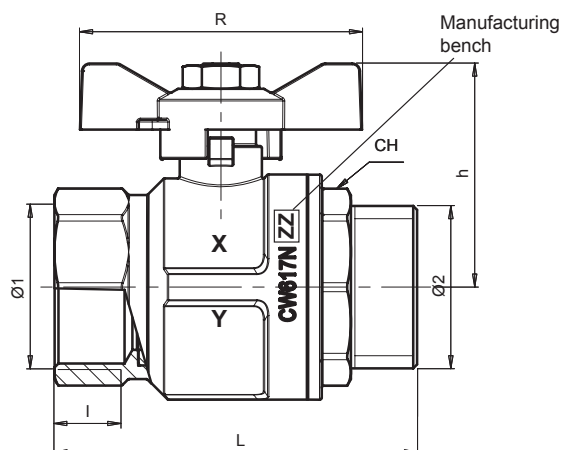
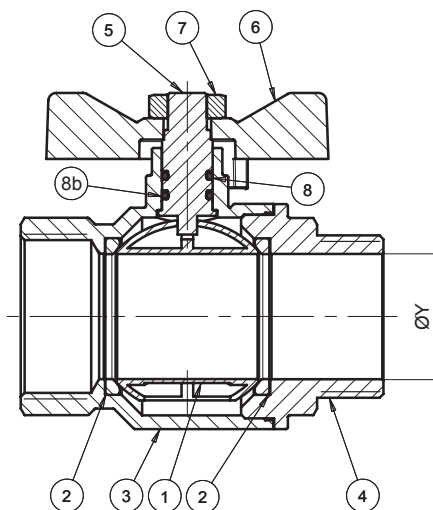
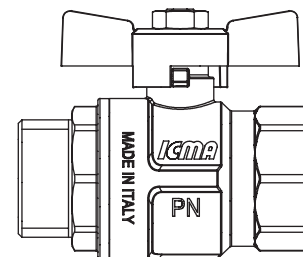

P.N.	DESCRIPTION	MATERIAL
1	SPHERE	CW617N - UNI EN 12165 - CHROME PLATED
2	SEAT GASKET	PTFE
3	BODY	CW617N - UNI EN 12165
4	SLEEVE	CW617N - UNI EN 12165
5	COMMAND ROD	CW617N - UNI EN 12165
6	HANDLE	RED COATED ALLOY
7	NUT	ZINC PLATED STEEL
8	O-RING	NBR
8b	O-RING	VITON

Dimensions

CODE	X		Y	ISO 228/1		L	I	R	CH	h
	SIZE	PN (bar)		DN	Ø 1 M					
87351AC11	3/8"	50	10	3/8"	3/8"	53,5	10	47	21	35
87351AD11	1/2"	50	15	1/2"	1/2"	59,5	11	54	25	39
87351AE11	3/4"	40	20	3/4"	3/4"	66,5	12	54	31	43
87351AF11	1"	40	25	1"	1"	78,5	14	64	38	47,5
87351AG11	1"1/4	30	32	1"1/4	1"1/4	92,5	18	72	47	57

Blue coated alloy handle option available for every size (sold separately).

Handle code:

01347AC12 - 3/8"

01347AD12 - 1/2" e 3/4"

01347AF12 - 1"

01347AG12 - 1" 1/4

Ball valve

351

/ Field of use

Min. operating temperature: -20°C with 50% glycol solutions
 Max operating temperature: 150°C
 Max operating pressure at 20°C

	3/8"	1/2"	3/4"	1"	1"1/4"
bar	50	50	40	40	30
psi	725	725	580	580	435

/ Pressure loss at 20°C

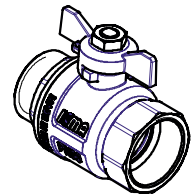
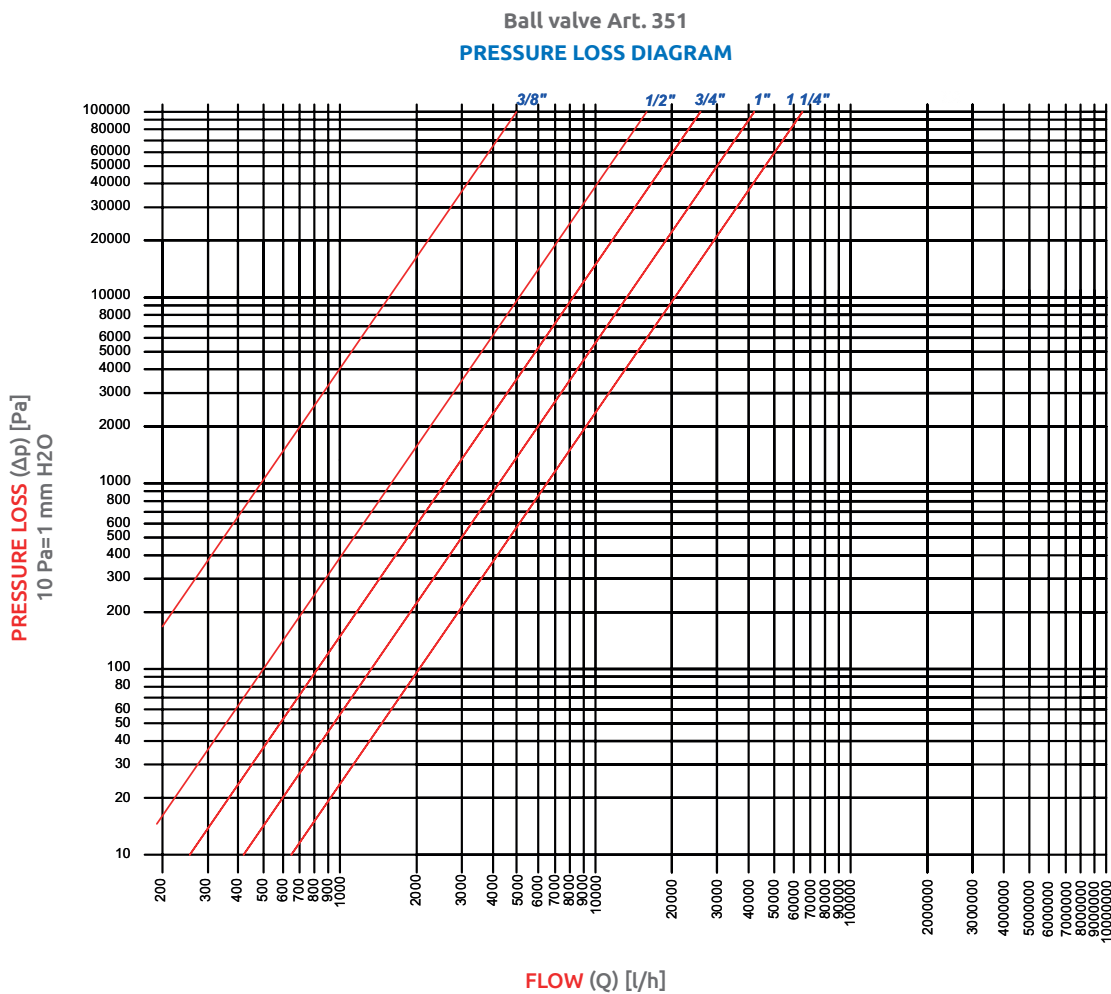

Size	Kv [m ³ /h]
3/8"	5,1
1/2"	15,5
3/4"	26,2
1"	41,4
1"1/4"	63,6